



## IMPORTANT!

KEEP THIS DOCUMENT TO ACCESS YOUR RESULTS



YOUR KIT REGISTRATION #



Register your kit online at [www.mysoiltesting.com](http://www.mysoiltesting.com)

### Collecting A Good Soil Sample

- Collect soil from 5-7 separate locations/spots within your desired testing area.
- The soil should be collected to a depth of 6 inches (15 cm).
- Combine the collected soil in a large plastic bag or bucket and mix thoroughly, breaking up any large chunks. (Samples should be free of any large plant material and other debris).
- Using the provided scoop, collect one level scoop of the mixed soil and add it to the jar containing DI water and nutrient adsorbing capsule. Firmly secure lid.  
**DO NOT DUMP WATER OUT OF JAR**

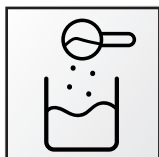

### Mail Your Sample To The Lab

- **MAIL YOUR SAMPLE WITHIN ONE DAY OF ADDING SOIL TO THE JAR**
- Ensure jar lid is firmly secure.
- Place jar in provided postage-paid envelope.
- Place envelope in your mailbox or anywhere USPS shipments are accepted.
- You will be emailed notifications of sample progress over the next 6-days or login at [www.mysoiltesting.com](http://www.mysoiltesting.com) for updates.

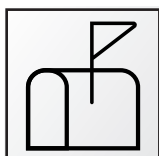

### Get Your Results

- You will be notified via email when your results are ready (6-8 business days from the time sample was sent) or login at [www.mysoiltesting.com](http://www.mysoiltesting.com) to check sample status.
- Provides:
  - Available nutrient levels and pH
  - Fertilizer recommendations and application rates
  - Easily shop recommended products from trusted vendors



### Amend Your Soil!

- Apply your recommended products at the directed rates.
- Don't forget to go to [www.mysoiltesting.com](http://www.mysoiltesting.com) for helpful insights to maximize the value of your application.



## Sample Planning

Soil test like a boss! An accurate soil sample provides accurate analysis.

Before taking your soil sample, it's best to evaluate your testing area and divide it into different sections if needed. For example, the sketch shown is a homeowner's backyard that wishes to collect samples for both a yard and garden. This example consists of a 7,600 square foot lawn and a 500 square foot garden.

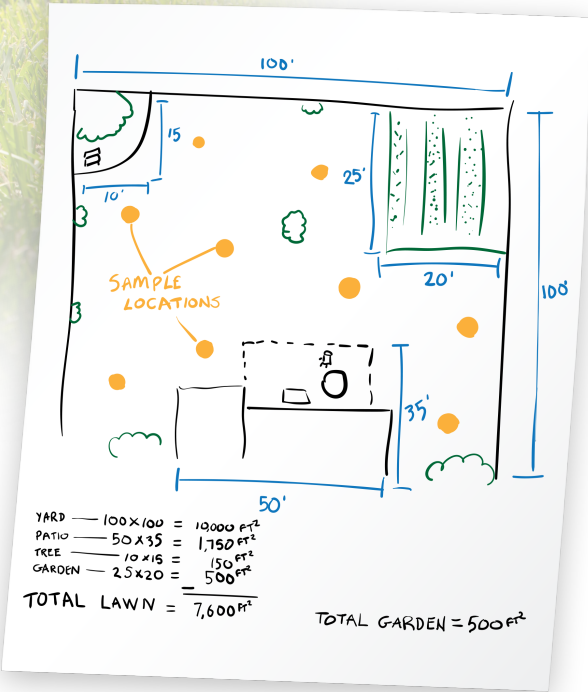

## Collect a Good Representative Sample

It is important to collect a representative soil sample. If multiple sample areas are being tested, we recommend separate tests for each area.

For each test, we recommend:

1. Pull soil from 5-7 different spots/locations to a depth of 6 inches
2. Use a large bag or bucket to collect the 5-7 subsamples
3. Thoroughly mix the 5-7 subsamples

Fill the provided scoop level with the thoroughly mixed composite sample and place it in the sample jar, with DI water and nutrient adsorbing capsule. Securely tighten the lid and place the filled jar in the provided prepaid mailing envelope.

## Sampling Tools

When collecting soil samples, we recommend using a soil probe, hand trowel or the MySoil Quick Sample!

